

Azimut 62 Flybridge

Year: 2009 - Hull number: 193



GENERAL DESCRIPTION

Year:	2009	Layout:	1 owner cab., 2 guest cab., 3 heads
Current Price:	EUR 835,000	Accommodation:	2 owner cab., 2 vip cab., 2 double cab.
VAT status:	Not paid	Crew:	1 cabin (1 crew) + 1 head
Laying:	Marina di Varazze, Varazze (Italy)	Hull color:	White
		Interiors:	Cherry woods & Cognac + Cream leathers

MACHINERY: 2 x CATERPILLAR C18 1.015 mHP (510 hrs, March 2014)

Shaft line

1 x Kohler 20 kW generator (350 hrs) – Shore Power 220/24V

ELECTRONICS & NAVIGATION:

Raymarine E wide pkg. (incl. 1x E80 at main helm + 1x E120 on fly, chart plotter) – ST6002 auto pilot - RAY E240 VHF (main hel + fly) – Chain counter - Radar antenna 18” 4 kW 72nm – Raymarine Sea Talk network - Maneuvering Joystick – TracVision M5 KVH Sat antenna - A/V complete system in salon w/receiver, VIP and guest – 32” LCD TV with elevator system in salon - I-Boat music player in salon.

COMPREHENSIVELY EQUIPPED:

A/C system 91.000 BTU - Bow thrusters – Stern thruster - Bathing platform with teak - Teak laid gangway - Teak laid cockpit floor – Electric winches in cockpit - Wood floor in dinette, galley and helm area – Barbecue & Fridge on fly - Galley equipped with electroceran glass hobs, refrigerator 230 lt - microwave oven + grill, Ice Maker – Dish washer machine – Washer/dryer machine - crockery with Azimut logo.

OTHER INFO: Enclosure for cockpit and fly - Sunbathing cushions and Cockpit cushions in ivory white color – Bimini on fly – Dimmered lights in saloon and cockpit – Electric pilot seat in helm station – Swimming Ladder

LAYOUT

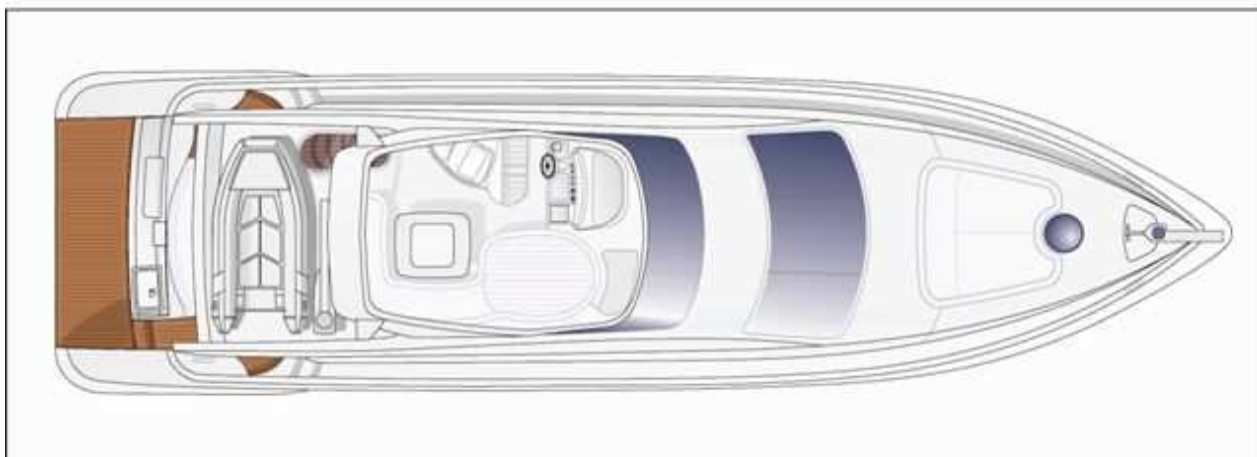

Flying Bridge



Main Deck

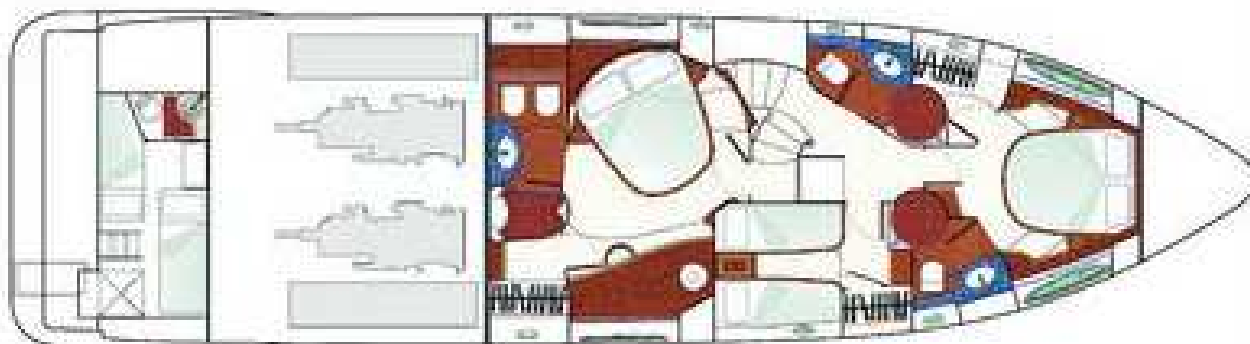

Lower Deck

ELECTRONICS & NAVIGATION



FLYBRIDGE



Image from the catalog



EXTERIOR



EXTERIOR con't



EXTERIOR con't



MAIN DECK



MAIN DECK con't



MAIN DECK con't



LOWER DECK (Owner cabin)





LOWER DECK (Vip cabin) con't



LOWER DECK (guest cabin) con't



- Guest cabin with two beds
- Private or daily head with shower

ENGINE ROOM



ADDITIONAL INFORMATION

Length overall (incl. pulpit)	19,86 m
Hull length (incl. platform)	19,25 m
Beam at main section	5,06 m
Draft (incl. props at full load)	1,51 m
Displacement (at full load)	30,27 t
Maximum speed (at half load)	33 kn
Cruising speed (at half load)	30 kn
Fuel capacity	3.740 l
Water capacity	1.000 l
Building material	GRP
Keel	planning
Exterior styling & concept	Stefano Righini
Interior Design	Carlo Galeazzi
Builder	Azimut Yachts

UNI ISO 8666

The performance described applies to a vessel with standard configuration (standard equipment installed) and a clean hull, propellers, and rudder. It is also noted that the performance described was recorded under favourable sea and wind conditions (Beaufort scale index 1, Douglas scale index 1); different and worse sea conditions could significantly impact performance.

CE Mark.

Given the continual evolution of technology, Azimut | Benetti S.p.A reserves the right to modify the technical specifications on its vessels at any time and without prior notice.

Disclaimer:

Any and all information contained in this brochure, including without limitation all technical data, performance, illustrations and drawings, are just a rough guide and they are not contractual and refer to standard models of motor yachts built by the shipyard. Therefore the only indications binding on the seller are contained solely in the sale agreement and in the relevant specific manual. This brochure is based on information available at the date of release. Notwithstanding all efforts to insure accuracy, the information contained in this email may not cover all details, technical-commercial changes subsequent to the date of issue, nor accurately foresee or report all possible scenarios. Displays, photos, schemes, designs or examples contained in this brochure are solely and exclusively reproduced to highlight the information contained. Due to the different characteristics of each yacht, the shipyard declines any and all liability for any use thereof on the basis of the information contained in this brochure.